

UP TO  
90,000 SF  
AVAILABLE

CLEAN ROOM AND OFFICE SPACE AVAILABLE  
WITH FREEWAY SIGNAGE

600 Millennium Drive, Allen, TX 75013



#### SPECS

- Millennium Business Park  
600 Millennium Drive  
Allen, TX 75013
- Up to 90,000 SF available
- US-75 visibility and monument signage
- Easy highway access
- On site facility management
- Flexible term (up to 10 years)
- Total Building 164,866 SF
- Shop 2,577 SF

#### OFFICE SPECS

- Total Office 71,914 SF
- Shell 24,202 SF
- Finished out 47,712 SF

#### CLEAN ROOM SPECS

- Class 1 4,046 SF
- Class 100 1,267 SF
- Class 1000 18,205 SF

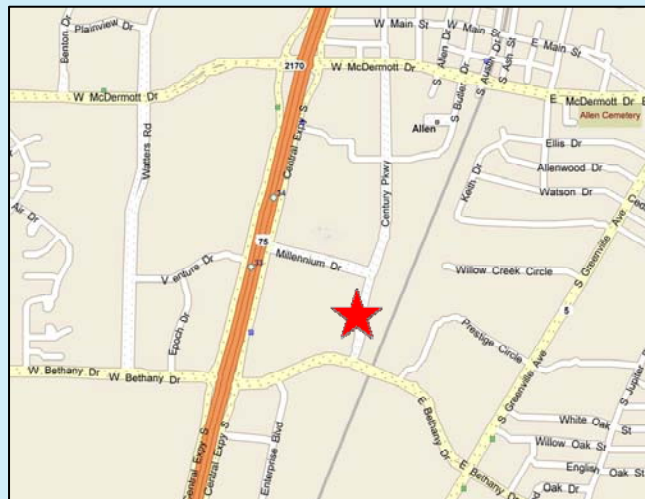

5001 Spring Valley Road, Ste. 600W  
Dallas, TX 75244

Ph: 972.774.2500 Fax: 972.774.2546  
www.transwestern.net

Brant P. Landry, SIOR  
972.774.2565  
brant.landry@transwestern.net

Henry Knapek  
972.774.2552  
henry.knapek@transwestern.net

Emily Candee  
972.774.2567  
emily.candee@transwestern.net

UP TO  
90,000 SF  
AVAILABLE

CLEAN ROOM AND OFFICE SPACE AVAILABLE  
WITH FREEWAY SIGNAGE

600 Millennium Drive, Allen, TX 75013

**SPECS**

- Millennium Business Park  
600 Millennium Drive  
Allen, TX 75013
- Up to 90,000 SF available
- US-75 visibility and monument signage
- Easy highway access
- On site facility management
- Flexible term (up to 10 years)
- Total Building 164,866 SF
- Shop 2,577 SF

**OFFICE SPECS**

- Total Office 71,914 SF
- Shell 24,202 SF
- Finished out 47,712 SF

**CLEAN ROOM SPECS**

- Class 1 4,046 SF
- Class 100 1,267 SF
- Class 1000 18,205 SF

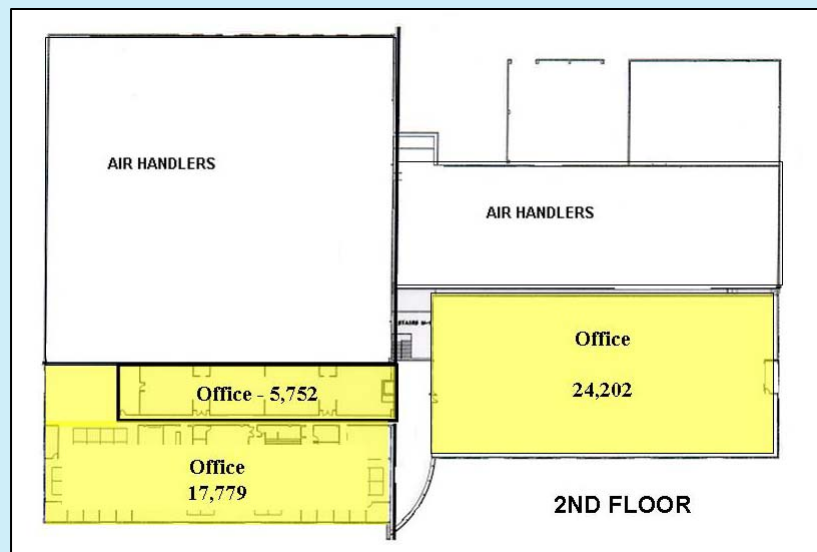
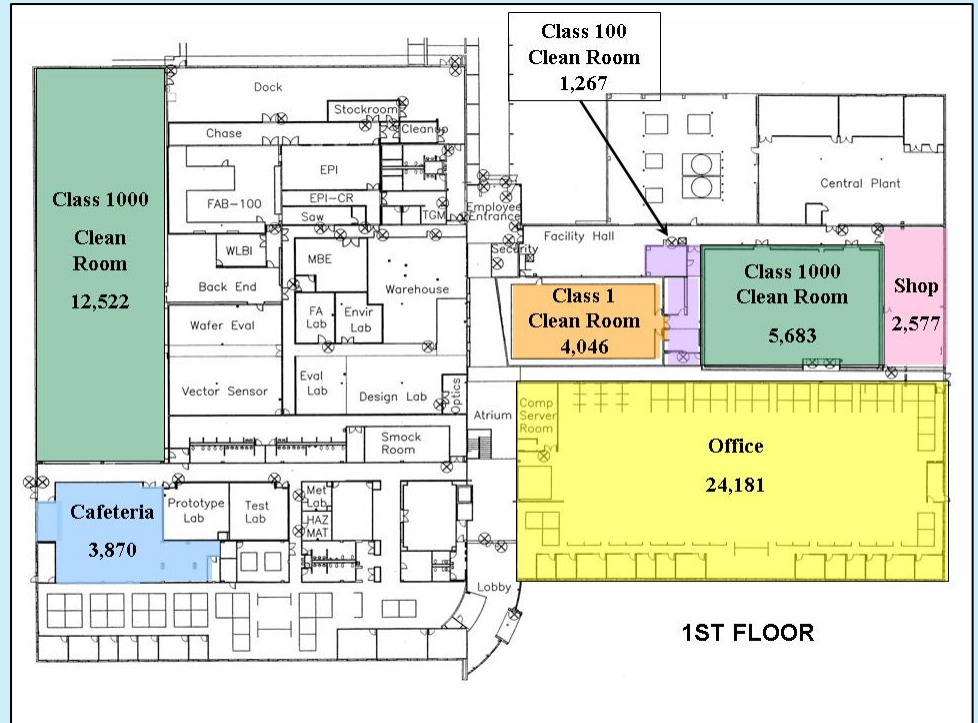

5001 Spring Valley Road, Ste. 600W  
Dallas, TX 75244

Ph: 972.774.2500 Fax: 972.774.2546  
www.transwestern.net

Brant P. Landry, SIOR  
972.774.2565  
brant.landry@transwestern.net

Henry Knapek  
972.774.2552  
henry.knapek@transwestern.net

Emily Candee  
972.774.2567  
emily.candee@transwestern.net

The information provided herein was obtained from sources believed reliable; however, Transwestern makes no guarantees, warranties, or representations as to the completeness or accuracy thereof. The presentation of this property is submitted subject to errors, omissions, change of price or conditions, prior sale or lease, or withdrawal without notice. Copyright © 2008 Transwestern.