

OFFICE SPACE/
CLEAN ROOM SPACE

UP TO
52,429 SF
AVAILABLE

CLEAN ROOM AND OFFICE SPACE AVAILABLE
WITH FREEWAY SIGNAGE
600 Millennium Drive, Allen, Texas 75013

BUILDING SPECS

- Millennium Business Park
600 Millennium Drive
Allen, TX 75013
- US-75 visibility and monument signage
- Easy highway access
- On site facility management
- Total Building - 164,866 SF
- 585 Autoparks
- Dock High Doors
- Sprinklered
- Cafeteria

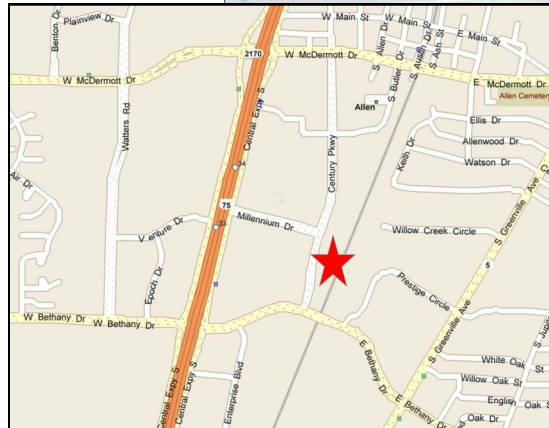

52,429 SF AVAILABLE FOR LEASE

CLEAN ROOM SPECS

- Class 1 4,046 SF

OFFICE SPECS

- Shell (2nd floor) 24,202 SF
- Finished out (1st floor) 24,181 SF
 - ⇒ Plug & Play
 - ⇒ 125 8' x 8' Cubes
 - ⇒ 14 Furnished Private Offices
 - ⇒ 3 Furnished Conference Rooms



5001 Spring Valley Road, Suite 600W • Dallas, Texas 75244
972.774.2500 • www.transwestern.net/dallas

FOR INFORMATION CONTACT:

Brant Landry, SIOR, CCIM
972.774.2565
brant.landry@transwestern.net

Henry Knappek
972.774.2552
henry.knappek@transwestern.net

Emily Candee
972.774.2567
emily.candee@transwestern.net

**OFFICE SPACE/
CLEAN ROOM SPACE**

**UP TO
52,429 SF
AVAILABLE**

**CLEAN ROOM AND OFFICE SPACE AVAILABLE
WITH FREEWAY SIGNAGE
600 Millennium Drive, Allen, Texas 75013**

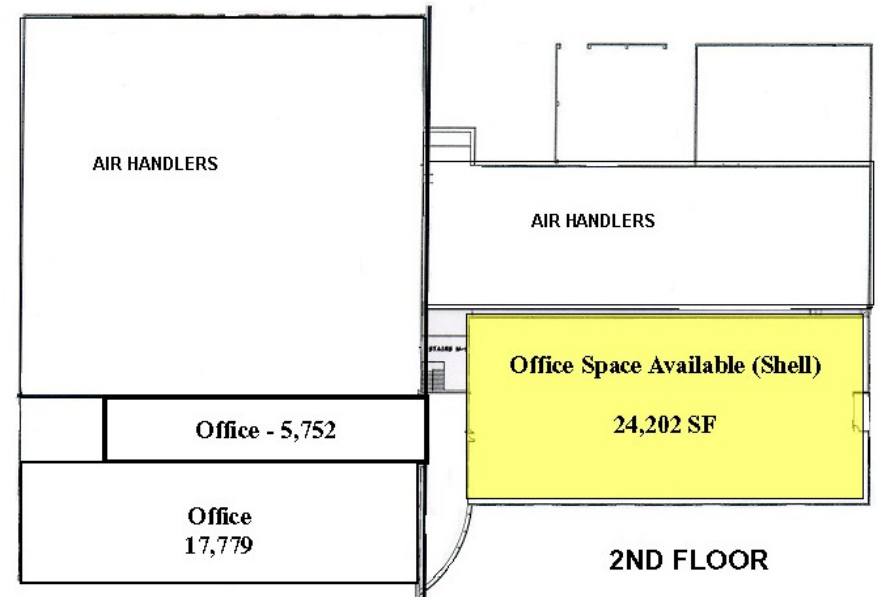
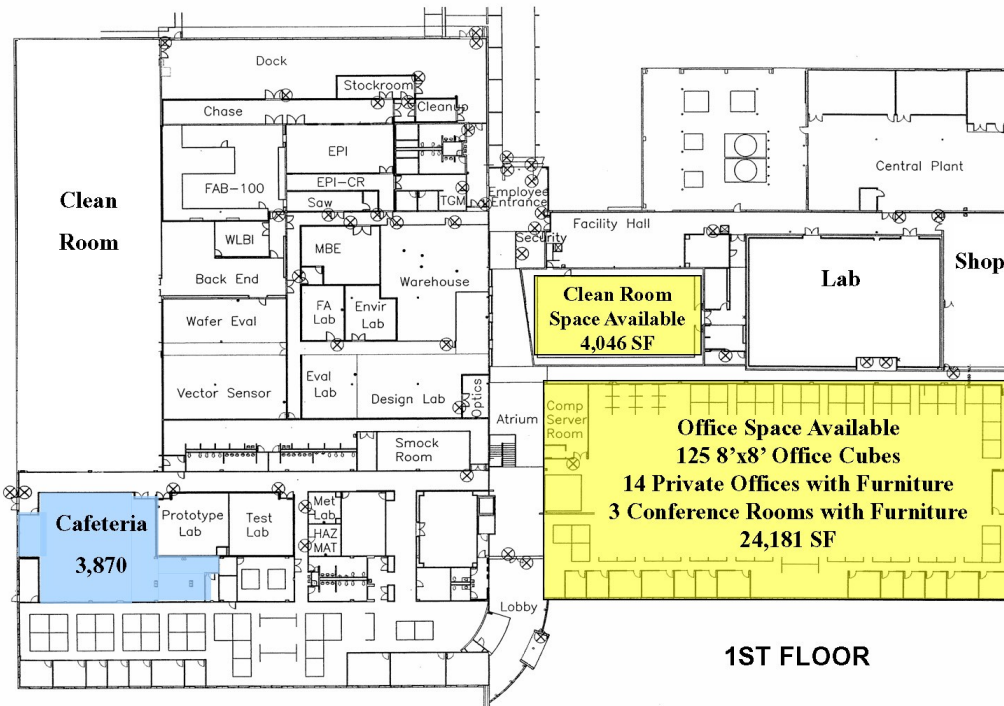

5001 Spring Valley Road, Suite 600W • Dallas, Texas 75244
972.774.2500 • www.transwestern.net/dallas

FOR INFORMATION CONTACT:

Brant Landry, SIOR, CCIM
972.774.2565
brant.landry@transwestern.net

Henry Knappek
972.774.2552
henry.knappek@transwestern.net

Emily Candee
972.774.2567
emily.candee@transwestern.net